



# KÄHLER - Strainer KSV

Welding ends

Fully Welded Design

DN 20 - 40 PN 40

Temp. max 180° C

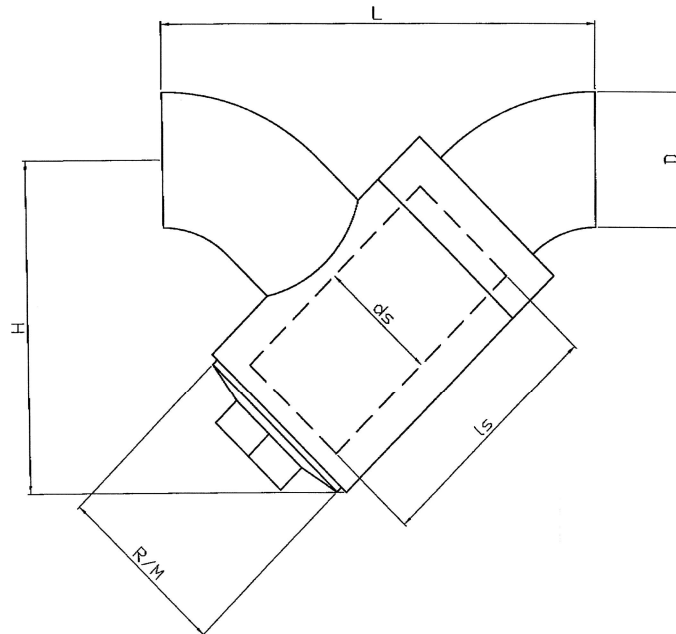

**DN 20 – DN 40**

**Mash Size**  
**0,7 mm (Standard)**

Plug Sealing: Silikon VMQ 60

KSV DN	PN	L	H	Ø D	WD SE	Is	Ø sp	R	M
20	40	150	100	26,9	3,2	80	25	1"	-
25	40	160	100	33,7	3,2	80	25	1"	-
25	40	400	100	33,7	3,2	80	25	1"	-
32	40	180	120	42,4	4,0	90	45	-	56 x 1,5
40	40	180	120	48,3	4,0	90	45	-	56 x 1,5

**Body:** St 37.0 / P235TR2  
**Welding Ends:** P265GH (1.0425)  
**Mash:** X5CrNi18-10 (1.4301)